

FORM No. 1.

Courses and distances Down the four mile run beginning at a Water Beech.

N 86	E 58
N 48	E 31
N 29	E 90
N 42	E 26
N 35	E 21
N 78	E 21
N 8	E 10
N 51	W 11
N 58	W 19
N 11	E 8.2
Perches 295.2	

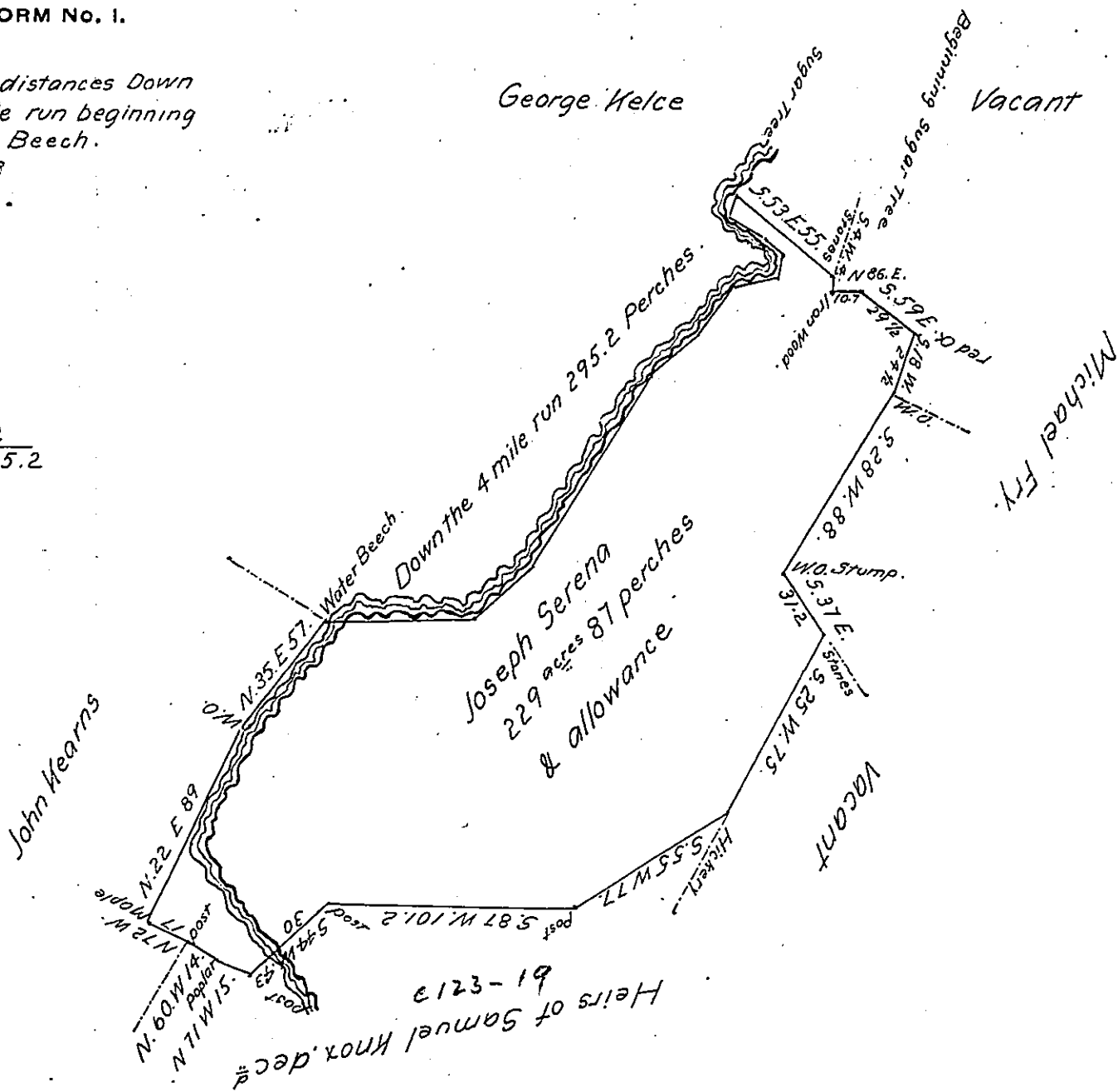

In pursuance of a Warrant granted to Joseph Serena dated December 9<sup>th</sup> 1829. Surveyed on the 18<sup>th</sup> day following the above described tract of land containing two hundred and twenty nine acres, eighty seven perches and the allowance proportioned at Six per Cent for roads &c. Situate on the four mile run in Ligonier township in the County of Westmoreland.

S. L. Carpenter D.S.

Gabriel Hiester Esq<sup>r</sup>  
 Surveyor General of Penna. }

IN TESTIMONY that the above is a copy of the original remaining on file in the Department of Internal Affairs of Pennsylvania, made conformably to an Act of Assembly approved the 16th day of February, 1833, I have hereunto set my Hand and caused the Seal of said Department to be affixed at Harrisburg, this Seventeenth day of December 1906.

*Haac R. Brown*  
 Secretary of Internal Affairs.